





**Bebauungsplan „Tassilo-Zöpf-Weg“  
Vierte Änderung gemäß § 13 BauGB**

-  Geltungsbereich der Änderung
-  Geltungsbereichsgrenze des Bebauungsplanes
-  Sichtdreieck

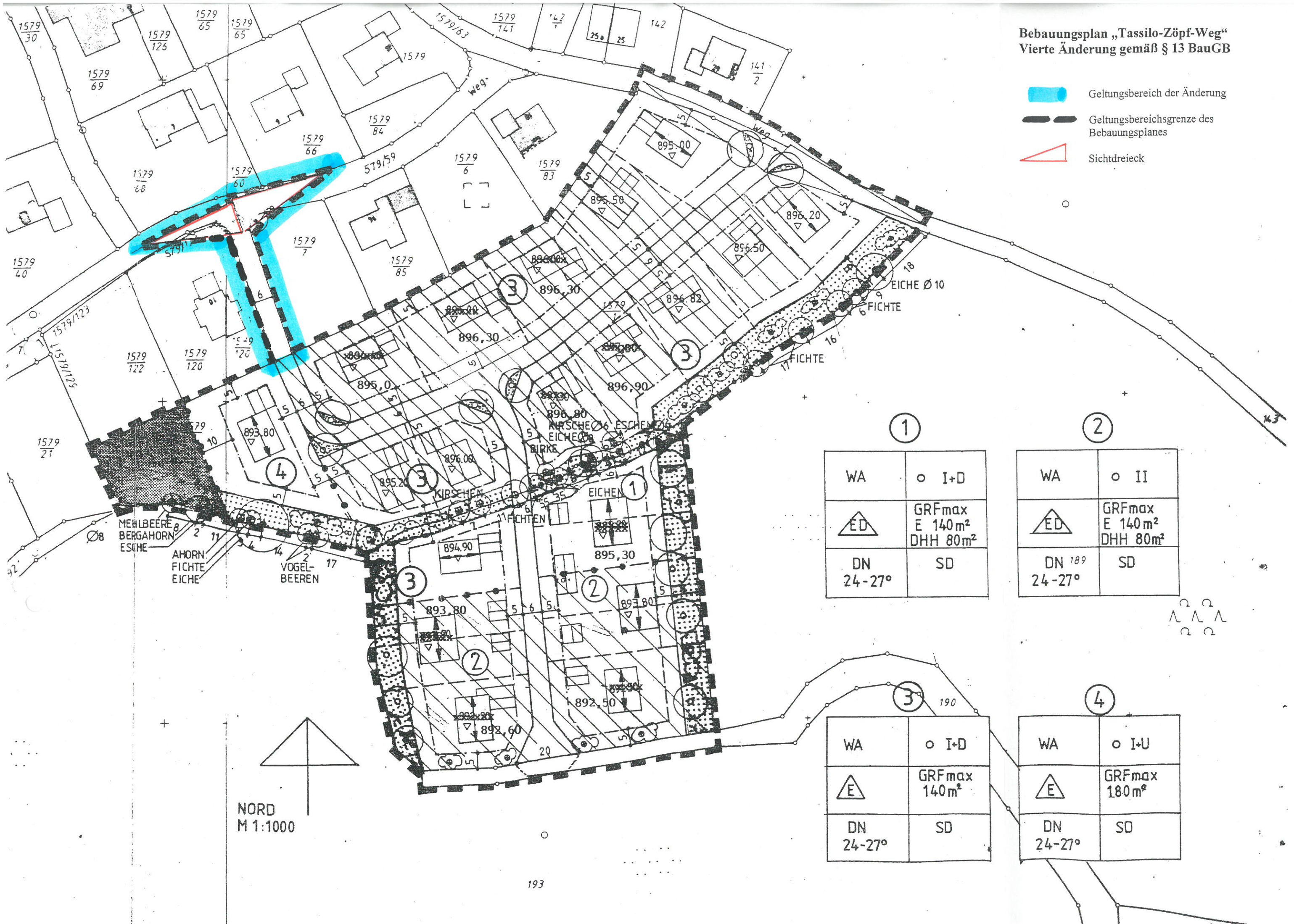

NORD  
M 1:1000

①

WA	○ I+D
	GRFmax E 140m <sup>2</sup> DHH 80m <sup>2</sup>
DN 24-27°	SD

②

WA	○ II
	GRFmax E 140m <sup>2</sup> DHH 80m <sup>2</sup>
DN <sup>189</sup> 24-27°	SD

③

WA	○ I+D
	GRFmax 140m <sup>2</sup>
DN 24-27°	SD

④

WA	○ I+U
	GRFmax 180m <sup>2</sup>
DN 24-27°	SD